

OLYMPIC®
SHOP EQUIPMENT

**INSTALLATION, OPERATION
& MAINTENANCE MANUAL**

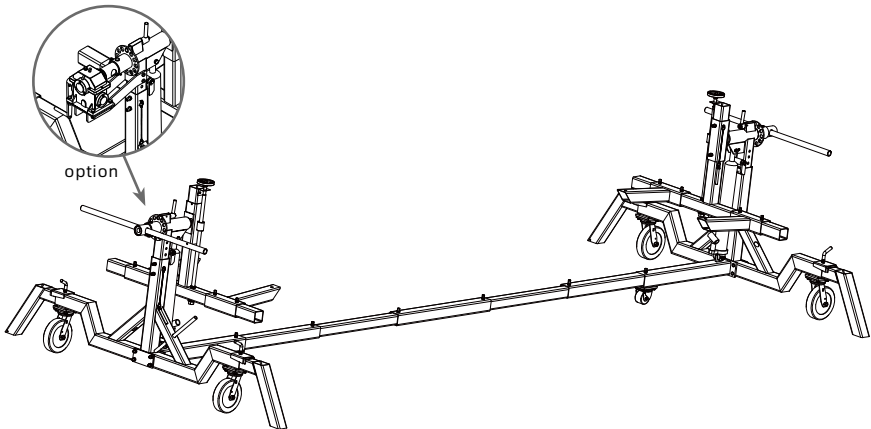

4,500 LB CAPACITY AUTOMOTNE ROTISSERIE



FOLLOW THIS MANUAL CAREFULLY TO ENSURE THE EQUIPMENT WILL FUNCTION CORRECTLY AND PROVIDE MANY YEARS OF DEPENDABLE SERVICE. FAILURE TO FOLLOW THESE INSTRUCTIONS AND SAFETY WARNINGS MAY RESULT IN PERSONAL INJURY OR PROPERTY DAMAGE. KEEP THIS MANUAL IN A SAFE DRY PLACE FOR FUTURE REFERENCE.

DESCRIPTION

This product should be used for repairing and maintaining automobiles. The vehicle can be lifted 49" and rotated 360°.

SPECIFICATIONS

Vax Height: 49"
Min Height: 22"
Max Length: 223"
Min Length: 125"

Width: 86.6"
Max Length Between Support Arms: 193"
Min Length Between Support Arms: 96"

SAFETY PRECAUTIONS

1. DO NOT exceed the rated capacity of 4,500 lb
2. Stay clear of the equipment when lifting or lowering
3. Keep the area around the equipment clear of obstacles
4. ALWAYS use the safety lock on the equipment

Prior to working with this rotisserie, always check for any obstructions that may interfere with the operation of the rotisserie such as: tools, air hoses, shop equipment, etc. These are generic instructions, please keep in mind there are different ways to hook up the same vehicle. Make sure to properly secure and balance vehicles center of gravity before using the rotisserie unit.

NOTE: There are no set rules when hooking up a vehicle. Make sure to utilize the structural mounting points on the vehicle.



CAUTION: IF YOU ATTEMPT TO ROTATE AN UNBALANCED VEHICLE YOU RISK INJURY, AN UNSAFE SITUATION, AND POSSIBLE DAMAGE TO YOUR VEHICLE.



WARNING: BEFORE OPERATING THE EQUIPMENT, MAKE SURE THAT ALL THE HARDWARE IS SECURE AND THAT EACH UNIT HAS BEEN TESTED PROPERLY.



WARNING: READ ENTIRE MANUAL AND COMPLY WITH ALL SAFETY AND SERVICE PRECAUTIONS. DEATH, PERSONAL INJURY AND / OR PROPERTY DAMAGE MAY OCCUR IF INSTRUCTIONS ARE NOT FOLLOWED CAREFULLY.

IMPORTANT INFORMATION

Any freight damage must be noted on the freight bill before signing and reported to the freight carrier with a freight claim established. Identify the components and check for shortages. If shortages are discovered, please contact the Distributor / Sales Rep. in your area for service.

Make sure you have extra help or heavy duty lifting equipment when unloading and assembling the Rotisserie unit.

Please read the safety procedures and operating instructions in this manual before operating Rotisserie unit. Keep this manual near Rotisserie unit at all times. Make sure all operators read this manual.

This is an Auto Body Rotisserie unit installation/operation manual and no attempt is made or implied herein to instruct the user in specific methods particular to an individual application. Rather, the contents of this manual are intended as a basis for operation and maintenance of the Rotisserie unit as it stands alone or as it is intended and anticipated to be used in conjunction with other equipment.

Proper application of the equipment described herein is limited to the parameters detailed in the specifications and the uses set forth in the descriptive passages. Any other proposed application of this equipment should be documented and submitted in writing to the factory for examination. The user assumes full responsibility for any equipment damage, personal injury, or alteration of the equipment described in this manual or any subsequent damages.

SAFETY PROCEDURES

Total Rotisserie unit capacity is 4,500lbs @ 2,250 lbs per end . Do not exceed maximum weight capacity.

Prior to working with Rotisserie unit, walk around and check for any objects that might interfere with the operation of unit such as: tools, air hoses, shop equipment, etc.

These are generic instructions, please keep in mind there are different ways to hook up the same vehicle. Make sure to properly secure and balance vehicles center of gravity before using the rotisserie.

NOTE: There are no set rules when hooking up a vehicle - just make sure there is a strong enough mounting point

GENERAL INFORMATION and FEATURES

The Auto Body Rotisserie is a restoration rotisserie that is designed to make restoring any vehicle a simple and easy task. The Auto Body Rotisserie uses heavy duty ram jacks at each end with a slow release mechanism for safe load lowering and also incorporates an extra long power stroke with hydraulic bypass valves preventing the cylinders from over traveling.

The Auto Body Rotisserie will also lower down to most bumper heights allowing capability to lift the body of the vehicle to any height.

Whether you're an owner of a large restoration shop or simply a home hobbyist, the Auto Body Rotisserie provides an efficient and affordable way for anyone to restore old classic vehicles.

INSTALLATION / OPERATION PROCEDURE

1. Install the 6 Caster Wheels to the bottom of each Rack Leg, Fig. 1. **NOTE: Do not over tighten bolts.** Install Upright to legs as shown, Fig. 1. You will install 7 bolts, flatwashers, lockwashers and nuts.

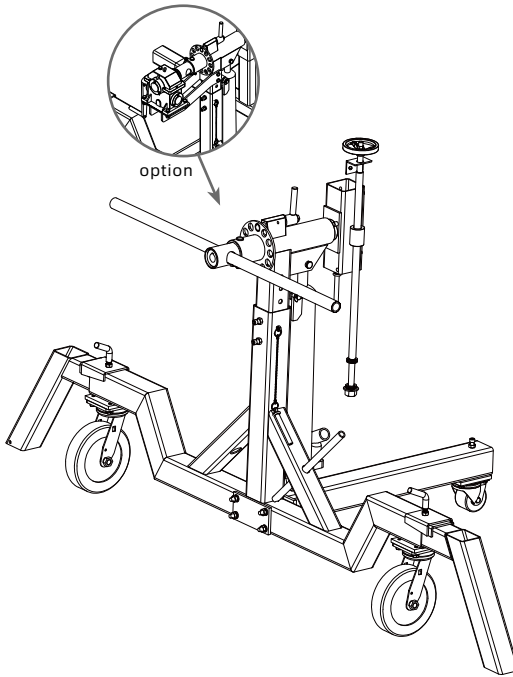

FIG

2. Install Horizontal Swing Arms as shown, Fig. 2.

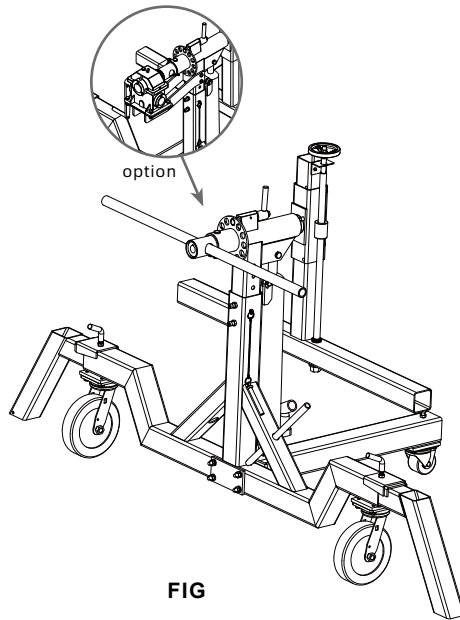

FIG

3. Install Adapter Arms, Fig. 3.

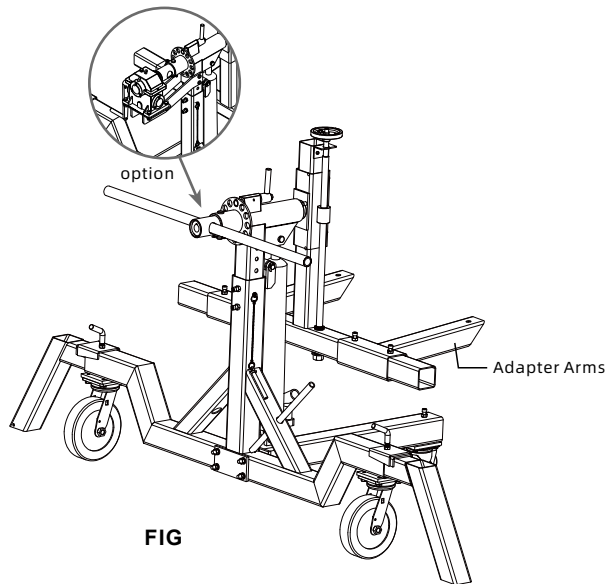

FIG

4. Apply good grade lithium shop grease to all sliding parts. This will provide for smooth and easier operation.
5. Check your mounting point for your particular vehicle. This can be different, depending on the make/model of your vehicle.
6. With the vehicle on Jack Stands, center the Auto Body Rotisserie bases to the front and rear of vehicle. **NOTE: Sometimes vehicles are heavier on one side and will need to be offset to that side.**
7. Mount the Auto Body Rotisserie Adapter Arms to the vehicle.
8. Place the Connecting Tubes in the center of the Rotisserie unit end pieces and tighten bolts, Fig. 4. **NOTE: Leave one end loose until ready to lift vehicle.**

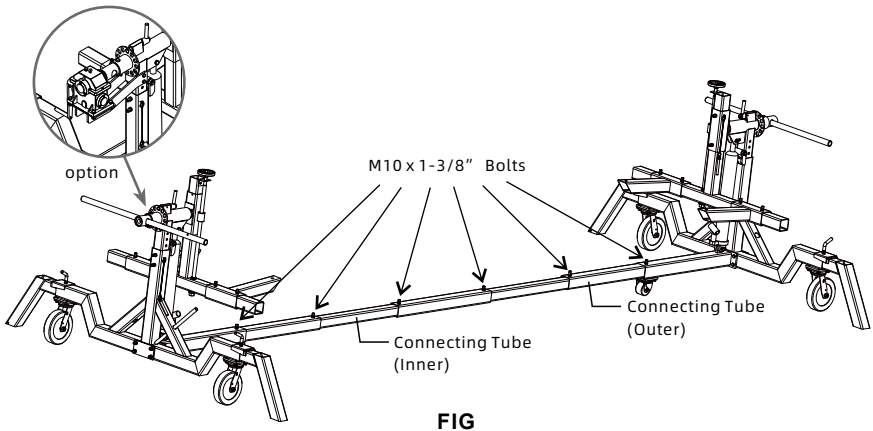

FIG

9. Check all mounting bolts to insure they are tightened properly and there is enough distance between the vehicle and Auto Body Rotisserie unit.
10. Make sure that Rotisserie bases are parallel to each other. Now you can fully tighten the Connecting Tubes.
11. Now begin lifting the vehicle up with the hydraulic cylinders. Lift just high enough to remove Jack Stands.
12. **NOTE:** The vehicle is not centered and balanced and will not spin yet. It will just swing like a clock pendulum.

See next section for proper "center of gravity" and balancing procedure

VEHICLE BALANCING OPERATION

(Adjusting the "Center of Gravity" of the Vehicle)

13. **CAUTION:** This is the most dangerous time during the use of the Auto Body Rotisserie unit. We have incorporated safety features that prohibit you from turning the Rotisserie unit while adjusting. This also prevents the unit from slipping while adjusting.

14. Always start with the Swing arms (upside down "T") as low as it can be.

NOTE: This will make the vehicle bottom heavy to help prevent causing an accident or personal injury.

15. Align the Rotation Balancer so the Balance Bolt/Arm fits into the welded cup located on top of the Pivot Point Base, Fig. 5. **NOTE:** This is what prevents you from turning while adjusting.

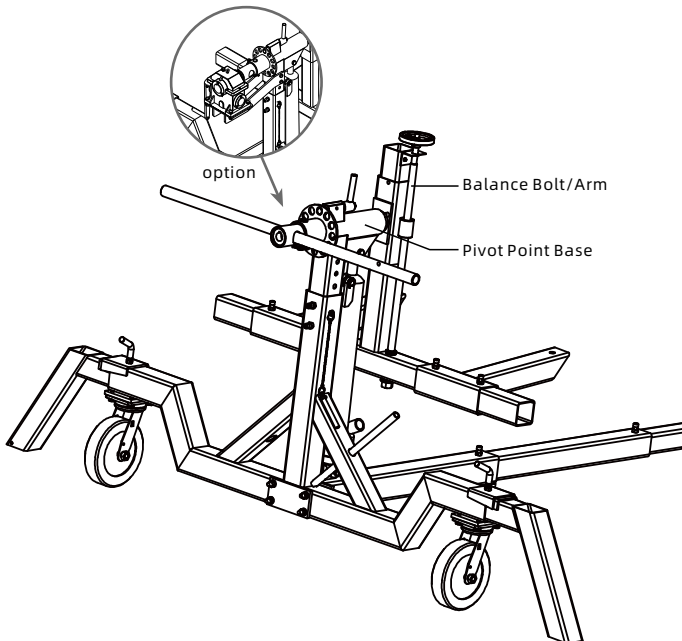

FIG

16. Raise the Swing arm up using a socket or impact wrench, being sure to move each end up only one hole at a time. This is to prevent any binding.
17. Put the large Bolt, Washer and Nut in the next hole and tighten.
18. Back out the Balance Rod enough to swing the vehicle.
19. Test the balance by swinging the vehicle from side to side.
20. If the vehicle is still bottom heavy REPEAT FROM STEP #15 testing the balance in each hole. **NOTE: As long as you don't jump over holes the difference from one hole to the next is never so great as to become uncontrollable.**

Hydra i Ra s

Capacity: 8T
 Stroke: 495mm
 min height: 630mm

N.W. 10kgs
 package size 680x150x110mm

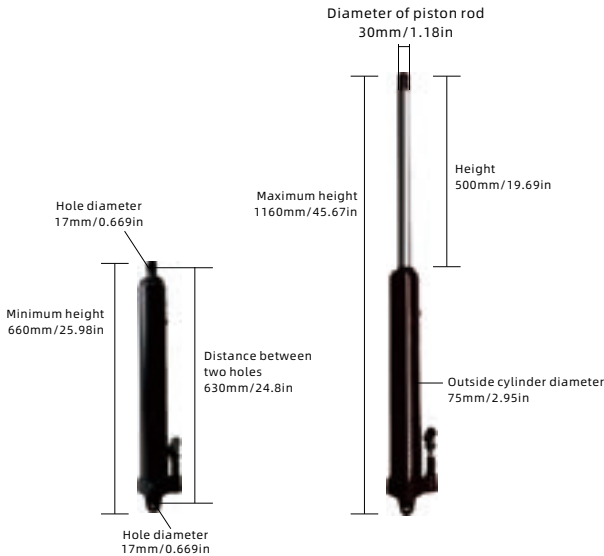

Hydraulic Fluid

If hydraulic fluid needs to be added to hydraulic cylinders, please use:

ISO Light Hydraulic Oil

Option : Gear-Box

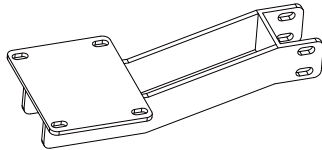
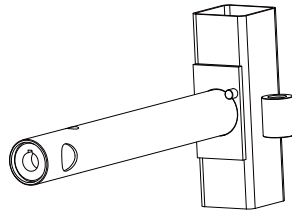
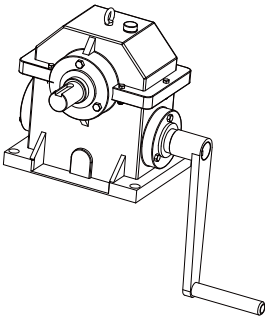

ILLUSTRATED PARTS BREAKDOWN

Auto Body Rotisserie Unit

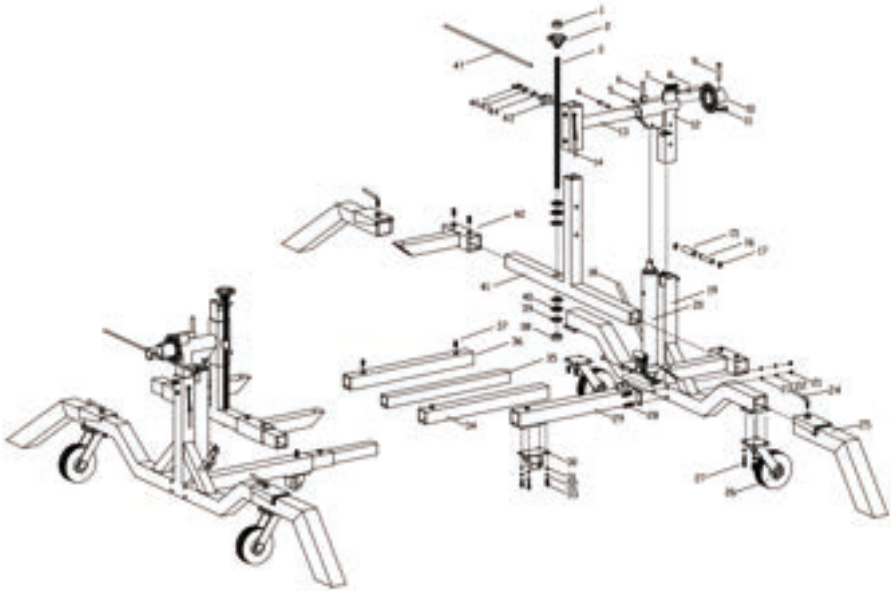

Rotisserie Parts Brea do n

Part No.	Description	Qty
1	Lock Nut M12	2
2	Adjustable Club	2
3	Adjust Screw	2
4	Bolt	2
5	Lock Nut M10	2
6	Wedge Handle	2
7	Spring	2
8	Locking Pin	2
9	Connecting Pin	2
10	Locking Plate	2
11	R-Pin	6
12	Lifting Stand	2
13	Rotating Stand	2
14	Safety Latch	2
15	Guide Sleeve	2
16	Guide Spindle	2
17	Circlip	4
18	Operation Handle	2
19	Main Stand	2
20	Pump	2
21	Nut	8
22	Spring CushionM10	24
23	Flat Pad M10	24
24	Fixed Handle	4
25	Support Frame	4
26	Wheel	4
27	ScrewM10	16
28	Bolt M10	8
29	Main Connecting Rod	2
30	Caster	2
31	Flat Pad M8	8
32	Spring Cushion M8	8
33	Screw M8	8
34	Connecting Rod	2
35	Extending Rod	2
36	intermediateExtendingRod	1
37	Bolt M10	22
38	Lock Nut	2
39	Washer	8
40	Bearing	4
41	Stand	2
42	Movable Stand	4
43	Positioning Clip	2
44	Spring Cushion M6	4
45	Flat Pad M6	4
46	Bolt M6	4
47	Handle	2

ILLUSTRATED PARTS BREAKDOWN

Auto Body Rotisserie Unit

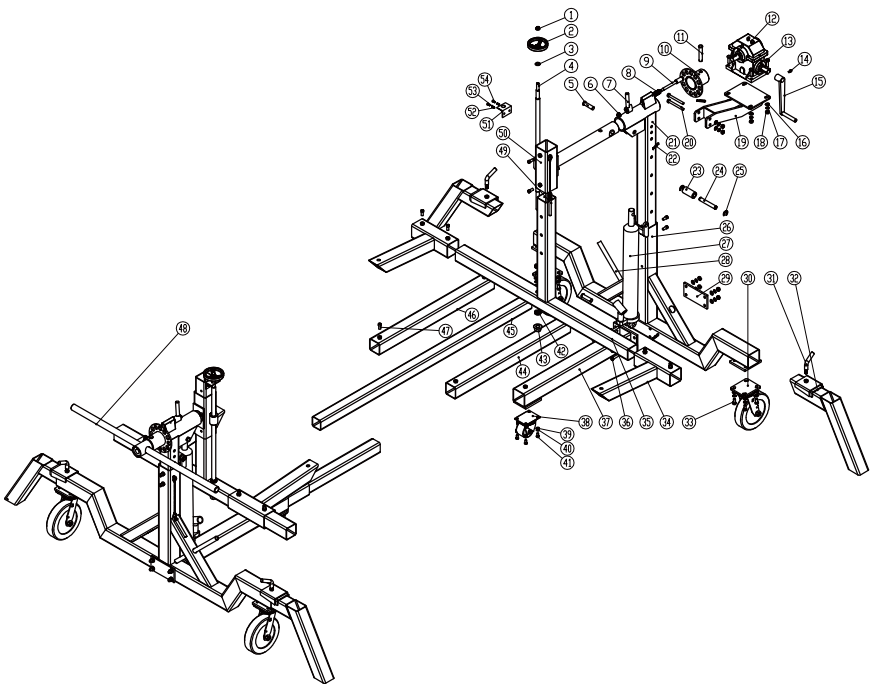

Rotisserie Parts Brea do n

Part No.	Description	Qty	Part No.	Description	Qty
1	Lock Nut M12	2	28	Operation Handle	2
2	Adjustable Club	2	29	Strengthening plate	2
3	Screw washer	2	30	Wheel	4
4	Adjust Screw	2	31	Fixed Handle	4
5	Bolt	2	32	Support Frame	4
6	Lock Nut M10	2	33	ScrewM10	16
7	wedge Handle	2	34	Movable Stand	4
8	Spring	2	35	Stand	2
9	Locking Pin	2	36	Bolt M10	8
10	Locking Plate	2	37	Main Connecting Rod	2
11	Connecting Pin	2	38	Caster	2
12	Gearbox	1	39	Flat Pad M8	8
13	Screw	4	40	Spring CushionM8	8
14	Fixing Screw M6	1	41	ScrewM8	8
15	Gearbox Handle	1	42	Washer Thrust Bearing	4
16	Flat Pad M10	30	43	Lock Nut	2
17	Spring CushionM10	30	44	Connecting Rod	2
18	Nut	14	45	Extending Rod	2
19	Gearbox Mounting Plate	1	46	IntermediateExtending Rod	1
20	Screw M10X100	2	47	Bolt M10	22
21	Lifting Stand	2	48	Handle	1
22	R-Pin	6	49	Safety Latch	4
23	Guide Sleeve	2	50	Rotating stand	2
24	Guide Spindle	2	51	Positioning Clip	2
25	Cirdlip	4	52	Flat Pad M6	4
26	Main Stand	2	53	Spring CushionM6	4
27	Pump	2	54	Bolt M6	4



WARNING

The warnings, precautions and instructions in this manual cannot cover all possible conditions and situations that may occur. The operator must understand that the operator must supply common sense and examine caution factors when using this product to determine safety in all circumstances being used.

Olympic Equipment 18935 59th Ave, NE, Arlington WA. 98223

Website: www.olympic-equipment.com

Email: info@olympic-equipment.com